



Letchworth Road Stanmore Offers over £324,950

A top floor, one bedroom flat available chain free with Davidson Frost-Wellings.

The flat has a large, open plan kitchen/ reception room with multiple windows offering lots of natural light throughout with access to a large roof terrace extending over 22'. There is also a spacious double bedroom with built-in wardrobes, a family bathroom and large utility cupboard.

Stanmore Place is in an excellent location for Canon's Park tube station. On site and included residents is a communal garden, gym, a children's playground, a 24 hour concierge and a secure parking space.

Leasehold with over 950 years remaining.
Service charge of approximately £3000 per annum.
Ground rent of £880 per annum.
Harrow Council tax band D.

Viewing

Please contact our Davidson Frost-Wellings Office on 020 8954 8806 if you wish to arrange a viewing appointment for this property or require further information.

- One bedroom
- Chain free
- Large roof terrace
- Secure parking
- Top floor (with lift)
- Long leasehold



Floor Plan

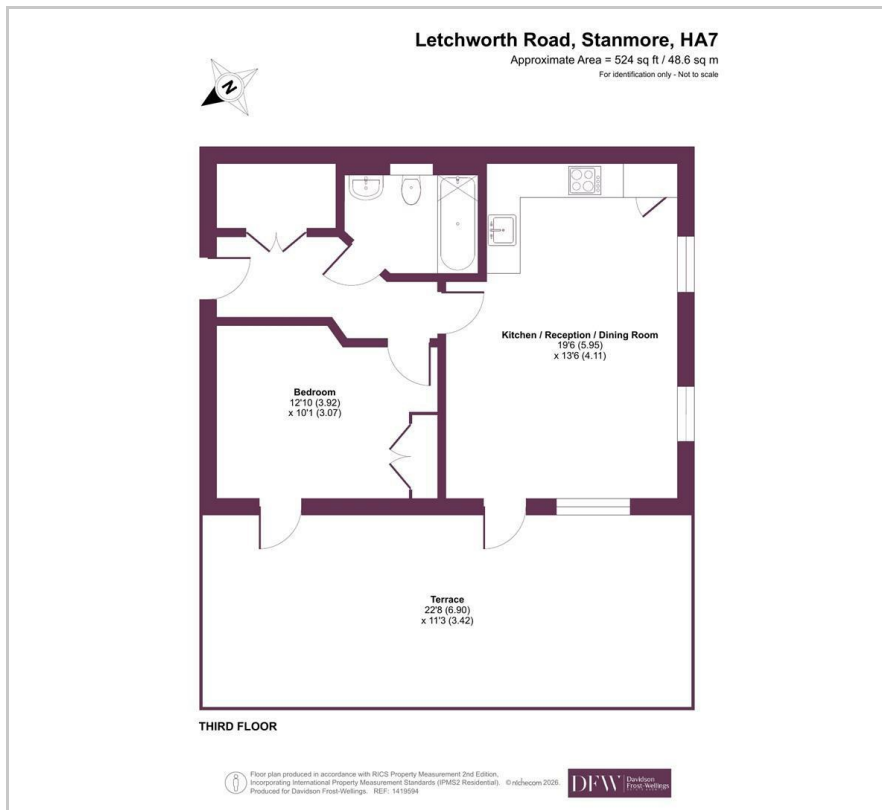

Area Map



Energy Efficiency Rating

	Current	Potential
<i>Very energy efficient - lower running costs</i>		
(92 plus) A		
(81-91) B		
(69-80) C	79	79
(55-68) D		
(39-54) E		
(21-38) F		
(1-20) G		
<i>Not energy efficient - higher running costs</i>		
England & Wales	EU Directive 2002/91/EC	



These particulars, whilst believed to be accurate are set out as a general outline only for guidance and do not constitute any part of an offer or contract. Intending purchasers should not rely on them as statements of representation of fact, but must satisfy themselves by inspection or otherwise as to their accuracy. No person in this firm's employment has the authority to make or give any representation or warranty in respect of the property.

47 The Broadway, Stanmore, HA7 4DJ

Tel: 020 8954 8806 Email: info@df-w.co.uk Website: www.df-w.co.uk